

# FYWK 20 YTH

Housing material

Composite for SKF Food Line

## Dimensions

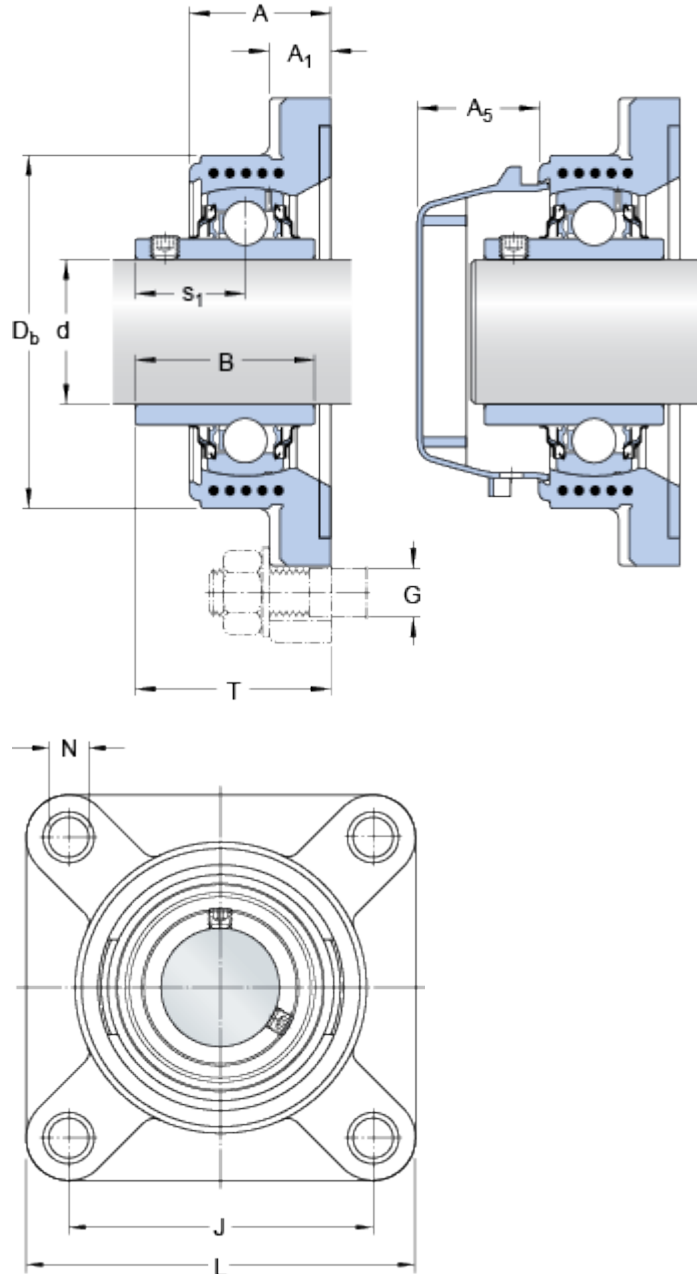

d	20	mm
A	30	mm
A <sub>1</sub>	15	mm
A <sub>5</sub>	26	mm
B	31	mm
D <sub>b</sub>	59	mm
J	63.5	mm
L	86	mm
N	12.3	mm
s <sub>1</sub>	18.3	mm
T	37.3	mm

**Dowel pins**

**Grease fitting**

**Threaded hole**

## Calculation data

Basic dynamic load rating	C	10.8	kN
Basic static load rating	C <sub>0</sub>	6.6	kN
Fatigue load limit	P <sub>u</sub>	0.28	kN
Limiting speed		5000	r/min

(with shaft tolerance h6)

## Mass

---

Mass bearing unit		0.3	kg
-------------------	--	-----	----

---

## Mounting information

---

Thread grub screw	G <sub>2</sub>	M6x0.75	
Hexagonal key size for grub screw	N	3	mm
Recommended tightening torque for grub screw		4	N·m
Recommended diameter for attachment bolts, mm	G	10	mm
Recommended diameter for attachment bolts, inch	G	0.375	in

---

## Appertaining products

---

Housing	FYWK 504 Y
Bearing	YAR 204-2RF/HV

---

## Appropriate products

---

End cover	ECW 204
-----------	---------

---